

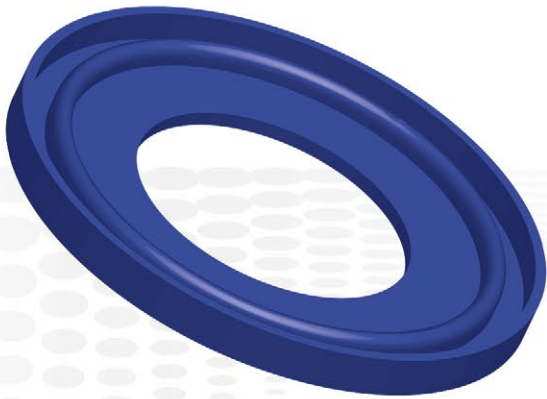

ASEPTIC SEALING



Expert in sealing solutions



www.seal-france.fr



+ 70 000 REFERENCES
EXPRESS DELIVERY
A TEAM OF EXPERTS

- **A WIDE RANGE**
Rotary - Hydraulic - Pneumatic - Aseptic
Machined parts



- **DELIVERY 24/48 H**
Order placed before 4pm (16h)
will be sent on the same day!



- **TECHNICAL SUPPORT**
Advises, helps and provides you technical assistance!



SUMMARY

ASEPTIC AND JR FITTING SEALS.....	2
• Features.....	2
• D-ring seals.....	4
• SMS seals.....	7
• Clamp seals.....	9
• SJR seals.....	15

ASEPTIC & SJR SEALS

2

DESCRIPTIVE

Aseptic and fitting seals (sanitary) are aimed to ensure the sealing between the components of a fluid transfer channel (valves, fittings, pumps) and composed of several profiles (Clamp, SMS, D Ring) with standardized dimensions.

Excellent adaptability to all temperatures, no extrusion and no cold flow. Aseptic seals are designed for food, cosmetics, pharmaceutical industries and wine production.

In order to meet the needs of the industries, we have the latest certifications (CE1935/2004 – ACS - KTW). We propose you clamp seals, SMS, D-Ring, SJR in NBR, EPDM, FPM, PTFE, SIL which meet the main standards (BOSD, SLS, DIN, ISO).



D-RING



RIMMED D-RING



SMS/R



SMS/L

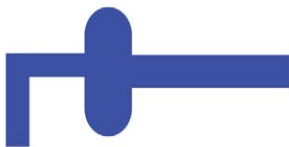

CLAMP TYPE " A "

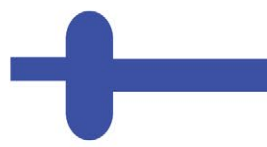

CLAMP TYPE " B "

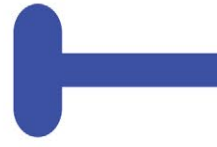

CLAMP TYPE " μ "



SJR

MATERIALS

Depending on different criteria and conditions of use defined by the user, the most adapted material will be recommended. A good technical diagnostic will ensure optimum seal tightness.

COMPOSITION

- FDA – USP CLASS 6
- 1935/2004 - ACS – KTW
- NBR
- EPDM
- FPM
- Virgin PTFE
- Silicone
- Other materials on request

CLAMP TYPE "A"



CLAMP seals are designed for large and very large shaft diameters. The elastomer core ensures good elasticity of the seal as well as good sealing duration. They are widely used in the food processing or pharmaceutical industries.

CLAMP TYPE "B"



Same description as type A but does not contain external lip.

CLAMP TYPE "μ" MICRO CLAMP



CLAMP Type "μ" is a mini CLAMP seal according to ASME/BPE and DIN 32676 (Series C).

SJR (FITTING SEALS)



SJR seals are used in male threaded connections in hydraulic applications. Its design allows quick and easy mounting.

D-RING



D-ring profile is used in the aseptic fitting according to DIN 11851. Widely used in food industry and in dairy sector.

RIMMED D-RING



Same description as D-Ring with a better sanitary performance because the D-ring type has a lip on the inside, covering the inside of the space in between the two metal parts.

SMS/R



SMS/R is an aseptic seal used in fittings in compliance with SMS 1149. It is mainly used in the food and pharmaceutical industries.

SMS/L



Same description as type SMS/R with a better sanitary design because the L-type has a lip on the inside, securing a smooth transition from pipe to pipe without a crevice.

D-RING

4

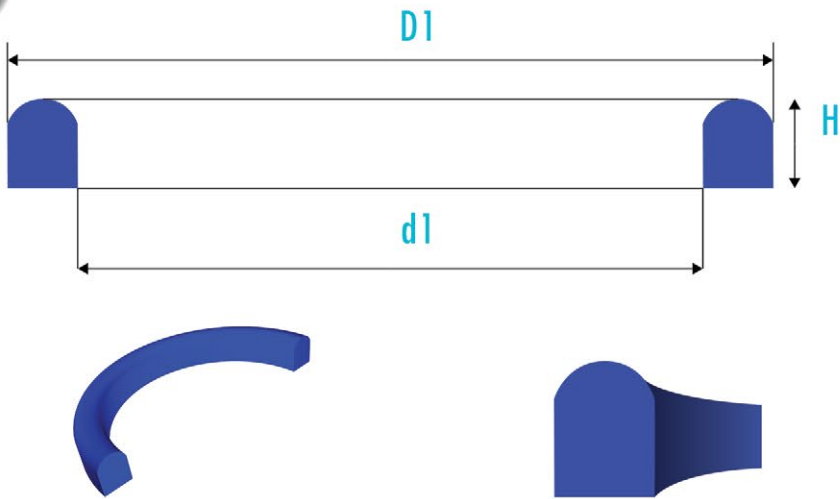

MATERIALS

FDA - USP CLASSE 6

1935/2004 - ACS — KTW

NBR

EPDM

FPM

VIRGIN PTFE

SILICONE

*OTHER MATERIALS ON REQUEST

DIMENSIONS / ACCORDING TO TUBE DIN 11851

Nominal diameter "DN"	Inner diameter "d1"	Outer diameter "D1"	Seal height "H"
10	12	20	4,5
15	18	26	4,5
20	23	33	4,5
25	30	40	5
32	36	46	5
40	42	52	5
50	54	64	5
50H	54	64	8
65	71	81	5
65H	71	81	8
80	85	95	5
80H	85	95	8
100	104	114	6
100H	104	114	6
125	130	142	7
150	155	167	7
150H	155	167	8

DIMENSIONS / ACCORDING TO BOSD

Nominal diameter "DN"	Inner diameter "d1"	Outer diameter "D1"	Seal height "H"
1"	25	35	5,5
1,5"	38	48	5,5
2»	51	61	5,5
2,5"	63	73,5	5,5
3"	76	86	5,5
4"	104	116	5,5

DIMENSIONS / ACCORDING TO SMS 1145

Nominal diameter "DN"	Inner diameter "d1"	Outer diameter "D1"	Seal height "H"
25	25	32	5,5
32	32	40	5,5
38	38	48	5,5
40	40	50	5,5
51	51	61	5,5
63	63	73,5	5,5
76	76	86	5,5

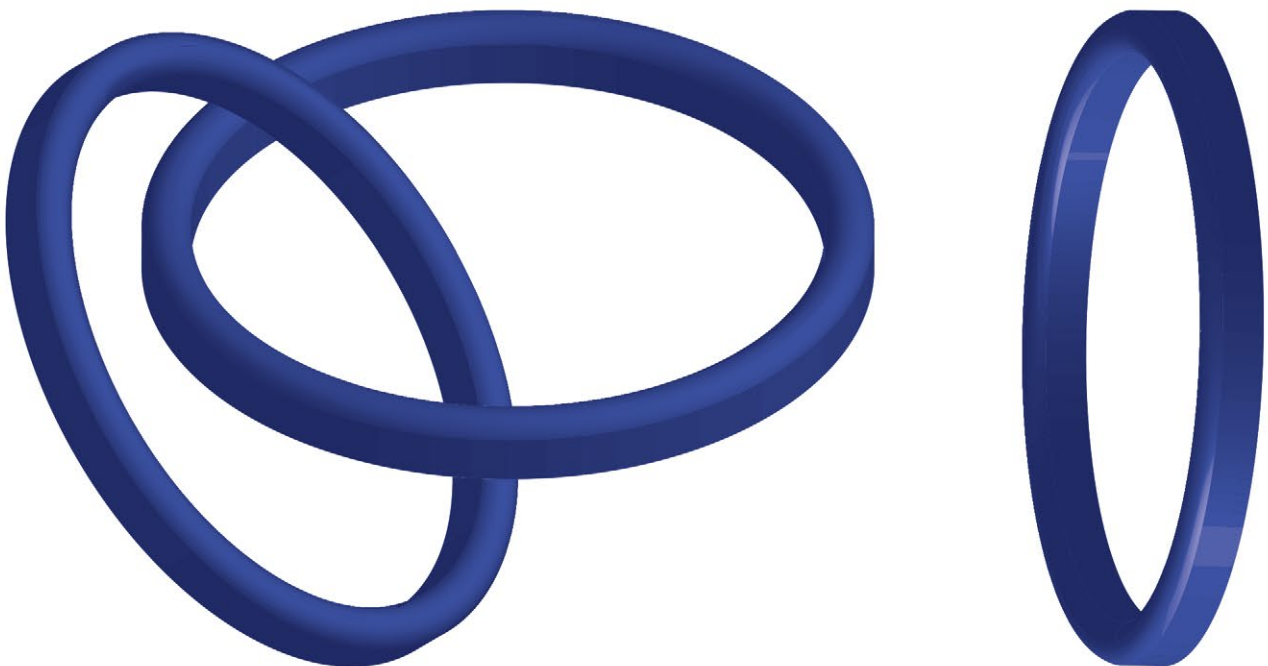

RIMMED D-RING

6

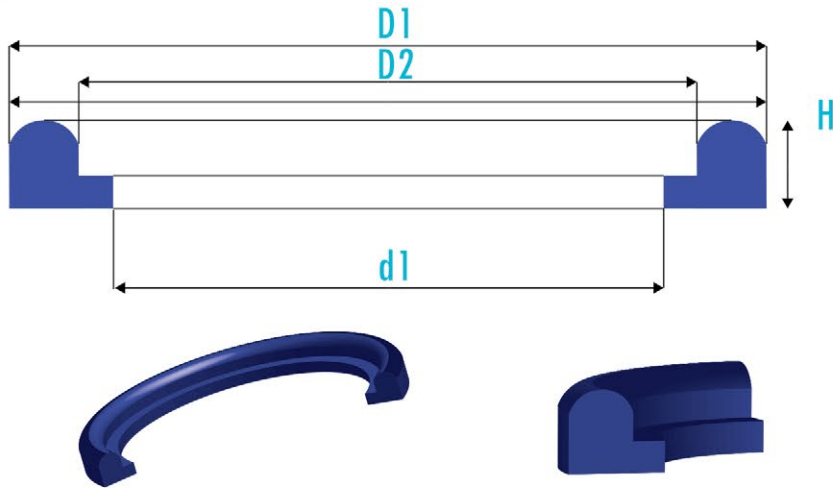

MATERIALS

FDA - USP CLASSE 6

1935/2004 - ACS — KTW

NBR

EPDM

FPM

VIRGIN PTFE

SILICONE

*OTHER MATERIALS ON REQUEST

DIMENSIONS / ACCORDING TO TUBE DIN 11851

Nominal diameter "DN"	Inner diameter "d1"	Outer diameter "D1"	Shoulder diameter "D2"	Seal height "H"
10	10	20	10,5	5
15	18	26	16,5	5
20	23	33	20,5	5
25	30	40	26,5	5
25H	30	40	26,5	6
32	36	46	32,5	6
40	42	52	38,8	6
50	54	64	50,5	6
65	71	81	66,5	6
80	85	95	81,5	6
100	104	114	100,5	6
125	130	142	125	7
150	155	167	150	7

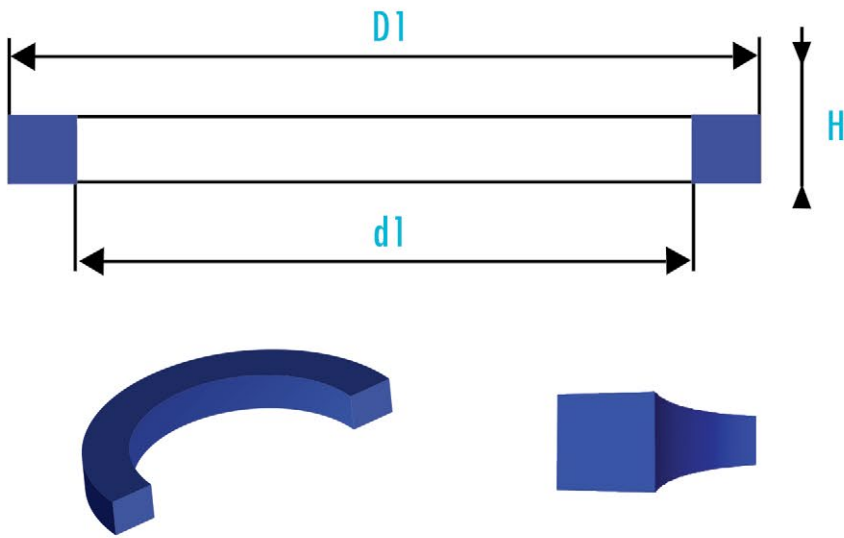

MATERIALS

FDA - USP CLASSE 6

1935/2004 - ACS – KTW

NBR

EPDM

FPM

VIRGIN PTFE

SILICONE

*OTHER MATERIALS ON REQUEST

DIMENSIONS

Nominal diameter "DN"	Inner diameter "d1"	Outer diameter "D1"	Seal height "H"
25	25	32	5,5
32	32	40	5,5
38	38	48	5,5
40	40	50	5,5
51	51	61	5,5
63	63,5	73,5	5,5
76	76	86	5,5
89	89	101	5,5
108	108	120	5,5

8

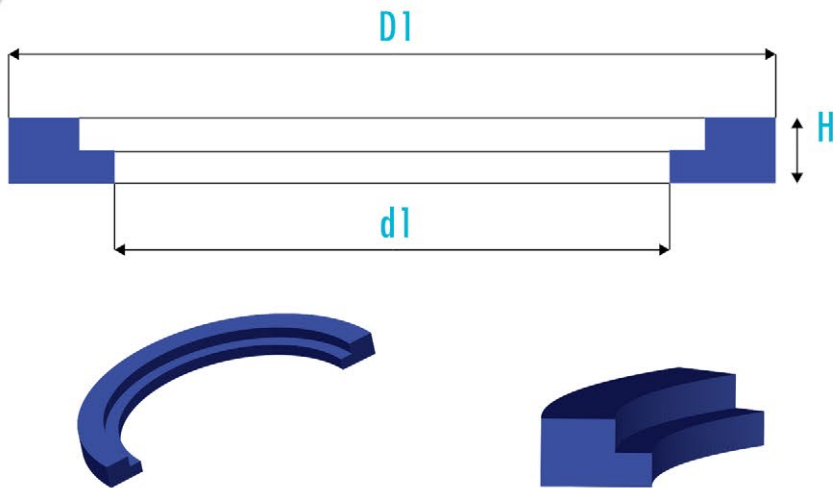

MATERIALS

FDA - USP CLASSE 6

1935/2004 - ACS — KTW

NBR

EPDM

FPM

VIRGIN PTFE

SILICONE

*OTHER MATERIALS ON REQUEST

DIMENSIONS

Nominal diameter "DN"	Inner diameter "d1"	Outer diameter "D1"	Seal height "H"
25	22,6	31,6	5,4
32	29,8	38,8	5,4
38	35,5	47,5	5,6
51	48,6	60,6	5,6
63	60,6	73	5,6
76	73,1	85,5	5,6
104	99,8	115	5,6

CLAMP SEAL TYPE "B" WITHOUT AN EXTERNAL LIP

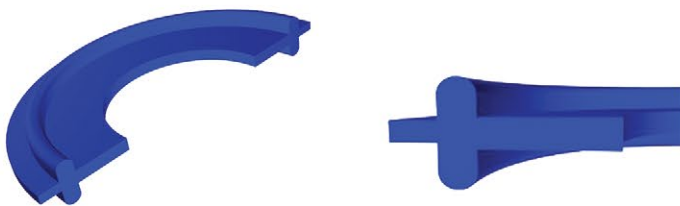

MATERIALS
FDA - USP CLASSE 6
1935/2004 - ACS – KTW
NBR
EPDM
FPM
VIRGIN PTFE
SILICONE
*OTHER MATERIALS ON REQUEST

DIMENSIONS / ACCORDING TO ISO 2852

	Nominal diameter "DN"	Inner diameter "d1"	Outer diameter "D1"	Seal height "H"
Mini clamp	12	10,2	34	-
	12,7	10,9	34	-
	17,2	15,4	34	-
	21,3	19,5	34	-
Clamp	25	22,8	50,5	-
	33,7	31,5	50,5	-
	38	35,8	50,5	-
	40	37,8	64	-
	51	48,8	64	-
	63,5	60,5	77,5	-
	70	67	91	-
	76,1	73,1	91	-
	88,9	85,1	106	-
	101,6	97,8	119	-
	114,3	110,5	130	-
	139,7	135,9	155	-
	168,3	163,3	183	-
	219,1	214,1	233,5	-

CLAMP SEAL TYPE "B" WITHOUT AN EXTERNAL LIP

10

DIMENSIONS / ACCORDING TO DIN 32676 METRIC SIZE

Nominal diameter "DN"	Inner diameter "d1"	Outer diameter "D1"	Seal height "H"
6	6,2	25	-
8	8,2	25	-

DIMENSIONS / ACCORDING TO DIN 32676 METRIC SIZE

Nominal diameter "DN"	Inner diameter "d1"	Outer diameter "D1"	Seal height "H"
10,2	7,2	25	-
13,5	10,5	25	-
17,5	14,5	25	-

DIMENSIONS / ACCORDING DIN 32676 IMPERIAL SIZE

Nominal diameter "DN"	Inner diameter "d1"	Outer diameter "D1"	Seal height "H"
1/4"	4,8	25	-
3/8"	8	25	-
1/2"	9,6	25	-
3/4"	16	25	-

TRI CLAMP UNION



CLAMP SEAL TYPE "A" WITHOUT AN EXTERNAL LIP

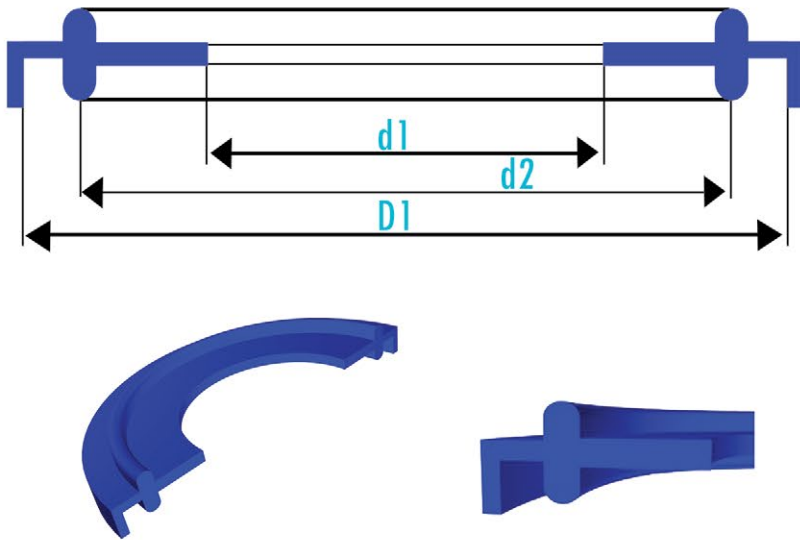

MATERIALS

FDA - USP CLASSE 6

1935/2004 - ACS – KTW

NBR

EPDM

FPM

VIRGIN PTFE

SILICONE

*OTHER MATERIALS ON REQUEST

11

DIMENSIONS / ACCORDING TO ISO 2852

Nominal diameter "DN"	Inner diameter "d1"	Inner diameter of the lip "D1"	Seal height "H"
12	10,2	34	-
12,7	10,9	34	-
17,2	15,4	34	-
21,3	19,5	34	-
25	22,8	50,5	-
33,7	31,5	50,5	-
38	35,8	50,5	-
40	37,8	64	-
51	48,8	64	-
63,5	60,5	77,5	-
70	67	91	-
76,1	73,1	91	-
88,9	85,1	106	-
101,6	97,8	119	-
114,3	110,5	130	-
139,7	135,9	155	-
168,3	163,3	183	-
219,1	214,1	233,5	-

CLAMP SEAL TYPE "A" WITHOUT AN EXTERNAL LIP

12

DIMENSIONS / ACCORDING TO DIN 32676 METRIC SIZE

Nominal diameter "DN"	Inner diameter "d1"	Inner diameter of the lip "D1"	Seal height "H"
10	10,2	34	-
15	16,2	34	-
20	20,2	34	-
25	26,2	50,5	-
32	32,2	50,5	-
40	38,2	50,5	-
50	50,2	64	-
65	66,2	91	-
80	81,2	106	-
100	100,2	119	-
125	125,2	155	-
150	150,2	183	-
200	200,2	233,5	-

DIMENSIONS / ACCORDING TO DIN 32676 METRIC SIZE

Nominal diameter "DN"	Inner diameter "d1"	Inner diameter of the lip "D1"	Seal height "H"
21,3	18,3	50,5	-
26,9	23,9	50,5	-
33,7	29,9	50,5	-
42,4	38,6	64	-
48,3	44,5	64	-
60,3	56,5	77,5	-
76,1	72,3	91	-
88,9	84,5	106	-
114,3	109,9	130	-
139,7	134,7	155	-
168,3	163,3	183	-
219,1	214,1	233,5	-

CLAMP SEAL TYPE "A" WITH AN EXTERNAL LIP

DIMENSIONS / ACCORDING TO DIN 32676 IMPERIAL SIZE

13

Nominal diameter "DN"	Inner diameter "d1"	Outer diameter "D1"	Seal height "H"
1"	22,3	50,5	-
1 1/2"	35	50,5	-
2"	47,7	64	-
2 1/2"	60,4	77,5	-
3"	73,1	91	-
4"	97,6	119	-
6"	147,1	167	-

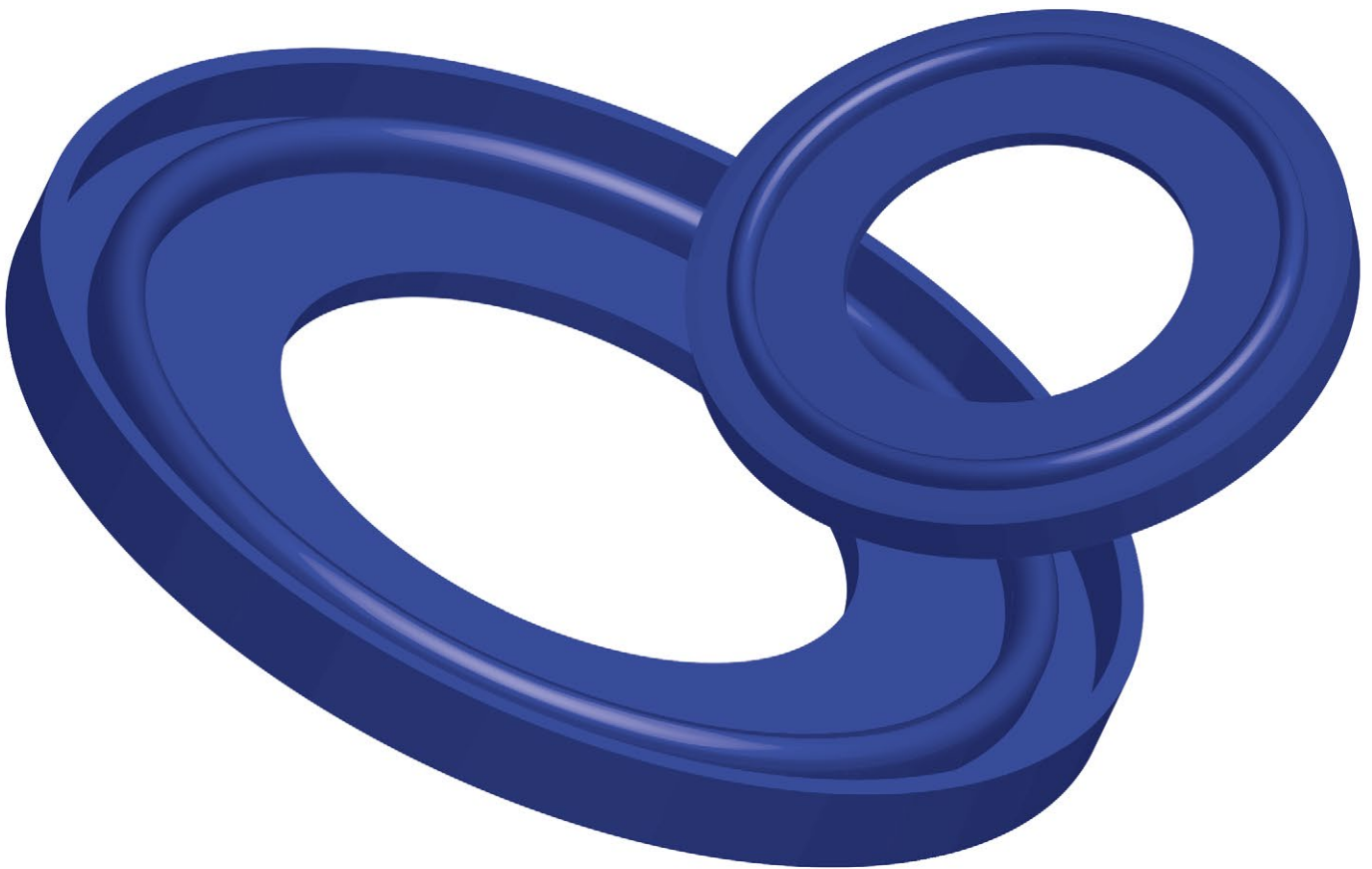

CLAMP SEALS TYPE "μ" MICRO CLAMP

14

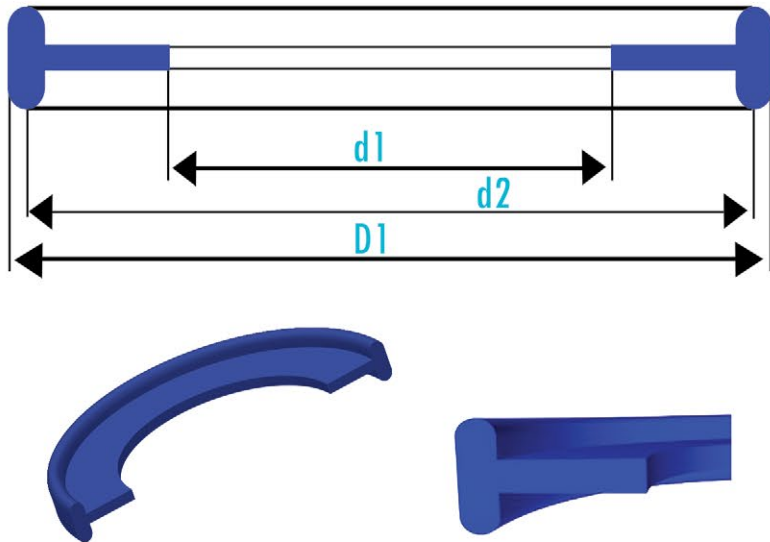

MATERIALS

FDA - USP CLASSE 6

1935/2004 - ACS – KTW

NBR

EPDM

FPM

VIRGIN PTFE

SILICONE

*OTHER MATERIALS ON REQUEST

DIMENSIONS / ACCORDING TO DIN 32676

Nominal diameter "DN"	Inner diameter "d1"	Inner diameter "d2"	Seal height "D1"
6	6	20	21,5
7	7	20	21,5
3/8	7,75	20	21,5
8	8	20	21,5
1/2	9,5	20	21,5
10	10	20	21,5
10,3	10,3	20	21,5
10,6	10,6	20	21,5
12	12	20	21,5
14	14	20	21,5
3/4	15,75	20	21,5
16	16	20	21,5

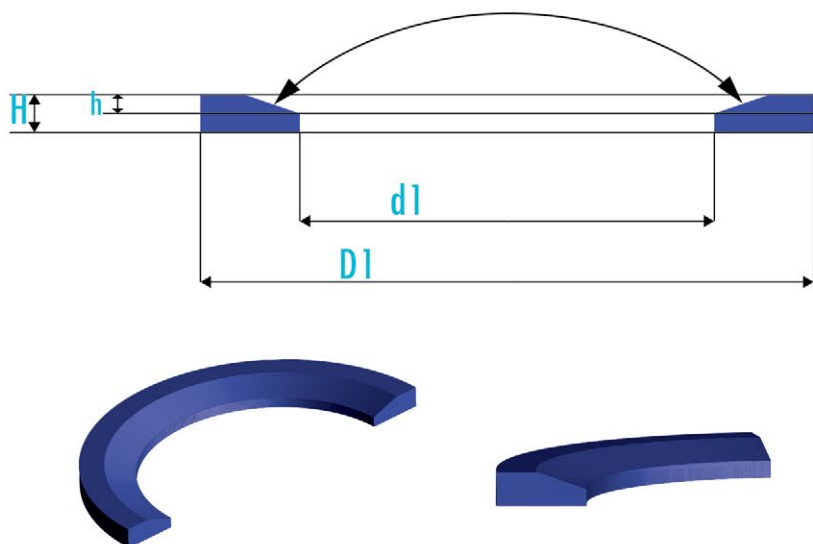

MATERIALS

FDA - USP CLASSE 6

1935/2004 - ACS – KTW

NBR

EPDM

FPM

VIRGIN PTFE

SILICONE

*OTHER MATERIALS ON REQUEST

DIMENSIONS / ACCORDING TO ISO 2852

Nominal diameter "DN"	Metric measure	No gas	Inner diameter "d1"	Inner diameter of the lip "D1"	Seal height "H"	Seal height "h"
8	M8X1,0	-	6,5	9,9	1	0,5
10	M10X1,0	G 1/8	8,4	11,9	1	0,5
12	M12X1,5	-	9,8	14,4	1,5	0,8
14	M14X1,5	G1/4	11,6	16,5	1,5	0,8
16	M16X1,5	-	13,8	18,9	1,5	0,8
17	-	G3/8	14,7	18,9	1,5	0,8
18	M18X1,5	-	15,7	20,9	1,5	0,8
20	M20X1,5	-	17,8	22,9	1,5	0,8
21	-	G1/2	18,5	23,9	1,5	0,8
22	M22X1,5	-	19,6	24,3	1,5	0,8
27	M27X2,0	G3/4	23,9	29,2	1,5	0,8
33	M33X2,0	G1	29,7	35,7	2	1
42	M42X2,0	G1 1/4	38,8	45,8	2	1
48	M48X2,0	G1 1/2	44,7	50,7	2	1

Material	Hardness	Temperature
NBR	85 SH	-30 °C +110°C
FPM	80 SH	-10°C +200°C
EPDM	70 SH	-30°C +140°C

ALL OUR AVAILABLE CATALOGUES

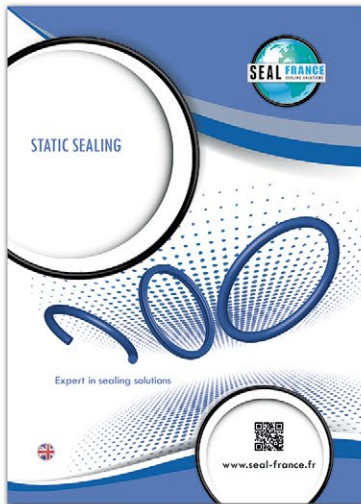

STATIC SEALING

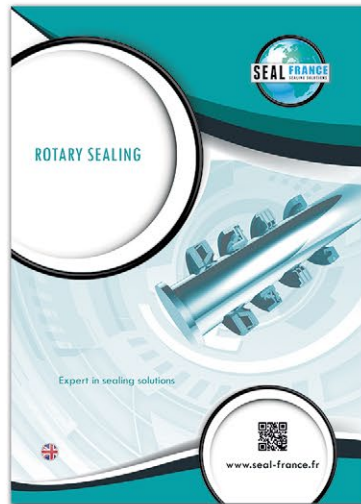

ROTARY SEALING



HYDRAULIC & PNEUMATIC SEALING



ASEPTIC SEALING



MACHINED PARTS



PRODUCTS RANGES



EXPERT IN SEALING SOLUTIONS FOR DISTRIBUTORS AND MANUFACTURERS

SEAL FRANCE is specialised in the sales and manufacturing of standard and customized sealing solutions. For over 20 years, our team of experts has advised, supported and provided technical assistance to its customers in a climate of trust. Thanks to its experience and know-how, SEAL FRANCE wishes to share its experience using appropriate tools adapted to your sealing systems.

A COMPLETE TRACEABILITY

Our materials are FDA, KTW, W270 or USP VI approved...

CUSTOM MANUFACTURING

For customized products, we propose you various methods of manufacturing to suit your needs.

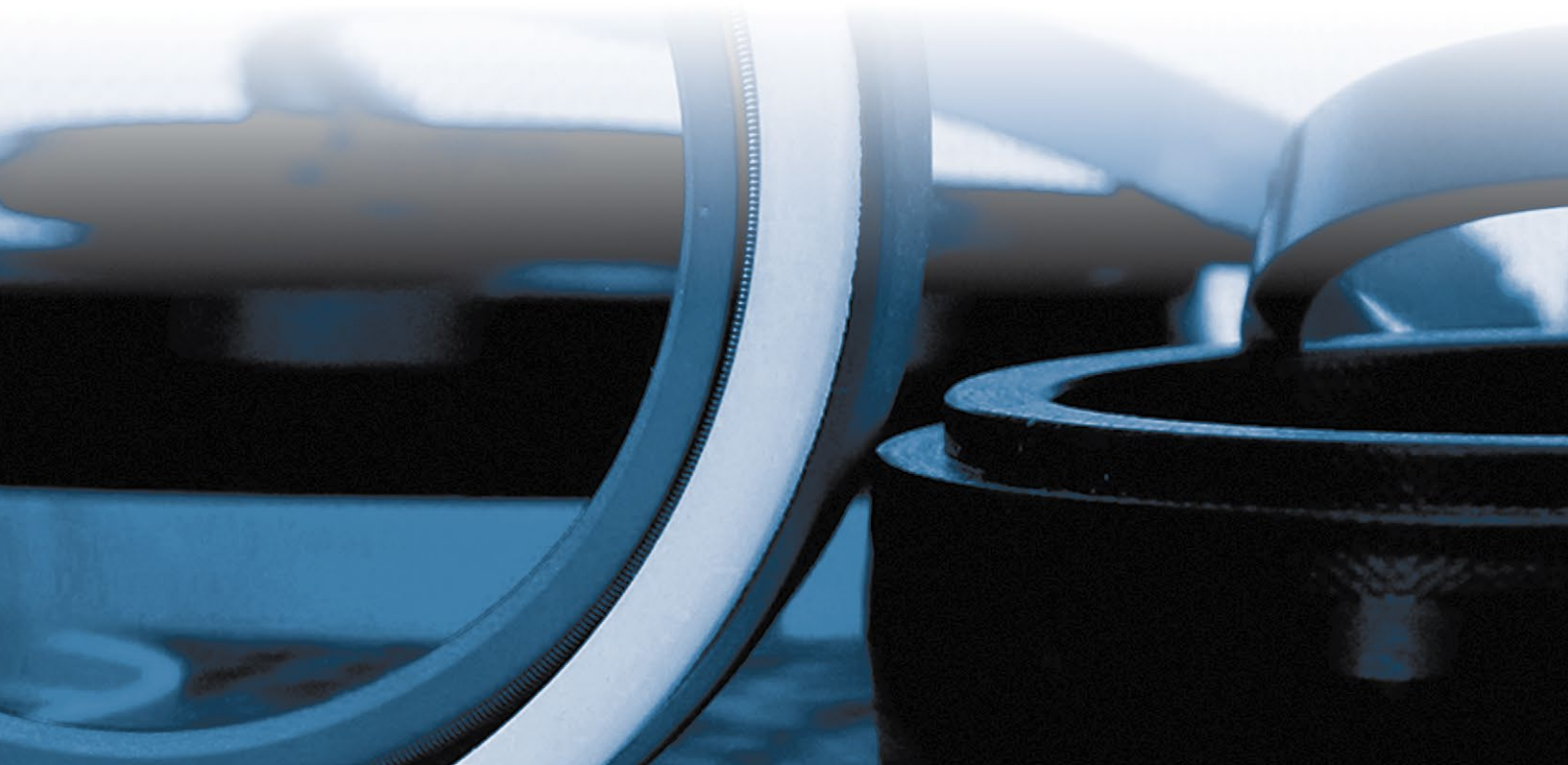



SEAL FRANCE

Espace Polygone
67 rue Ettore BUGATTI
66000 PERPIGNAN
FRANCE

☎ +33 (0)4 68 52 91 91

📠 +33 (0)4 68 52 91 90

Sales



contact@sealfrance.fr

Export



export@sealfrance.fr
patricknoack@sealfrance.fr

Accounting & Administration



benedictebertrand@sealfrance.fr

